

# THE GAP

## The 10th Virtual Design World Cup

### Guardian



## Concept

For thousands of years, the Gap in the rainforest has been the key to make the new life thriving. As the Gap, the development of the new capital city in east Kalimantan brings the light to the city with serious issues such as heavy traffic, flood, kinds of pollution and so on. In our project, to sustain the rainforest and provide a better live for the residences, we try to create the "Gap" in the new city by combining the brand new traffic system, connecting the rainforest environment and digital entertainment, to reach the balance between the ecosystem and development.

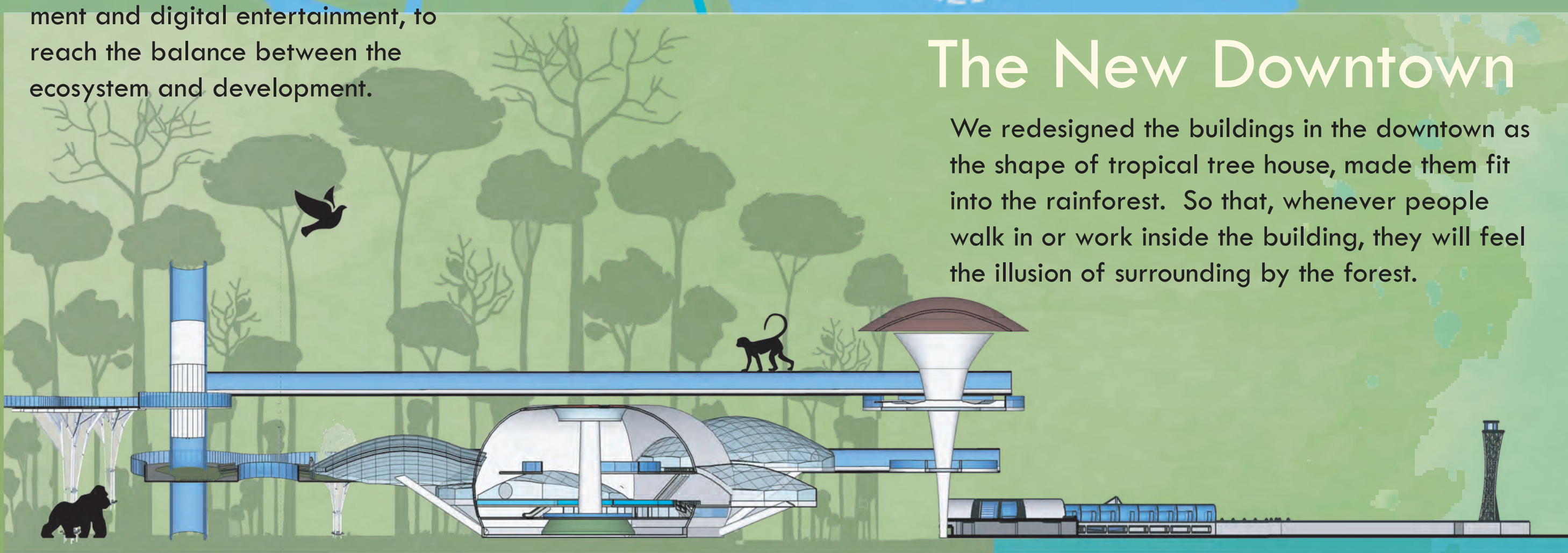

## The New Downtown

We redesigned the buildings in the downtown as the shape of tropical tree house, made them fit into the rainforest. So that, whenever people walk in or work inside the building, they will feel the illusion of surrounding by the forest.



## Entertainment

We combined the entertainment with the traffic, so the transportation could be a recreational facility, and the recreational facility could also be a transportation.

## Epidemic prevention

This year, due to the impact by Covid-19, epidemic prevention has become an important issue in every country. Therefore, we established some quarantine stations in both train stations and the ports. While passengers are about to take the public transportation, there will be a scanner taking their body temperatures and start to sanitize. We will also check every passengers' traces by scanning their personal ID to determine whether the passengers are secure or not. Simultaneously, we set a lighthouse in the port, which can represent different situations by changing the color of light---red light means warning, and green light represent safe---so the ships from voyage or the local residents could realize the epidemic of the capital with the color of the light on the lighthouse.

## Disaster prevention

Since the current capital Jakarta suffered from some environmental disasters, such as rising sea level. To solve these problems, we combined disaster prevention evacuation system with the new transportation---UNITs. Take the Rafflesia UNIT Stations for example, after the disaster hits, people can follow the instructions to get to the assigned platform, take the units and evacuate to safe shelters.

## Stratification Residential District

To reduce the destruction of the rainforest and establish a different living space in the new capital, we came up with a new living arrangement---"Stratification Residential District". We changed the life functions in the horizontal direction into vertical stratification, and each layer has been connected by the tunnels and the UNITs. By doing so, there was no need to sacrifice large tracts of the rainforest but still could retain the urban life functions.

## Eco-friendly

To avoid the tunnels and the stratification living area affect the habitat of original species too much, we came up with an idea called "the Cell", an extending space that can help the plants or other creatures to live across the artificial areas. By placing these Cells at every corner of the new capital, we hope that can reduce some damages that came along with the development.

## Traffic

In order to achieve the goal of symbiosis with the rainforest, we tried to replace the current traffic systems with a new type of transportation---"the UNIT". It is a globe transportation which can not only take passengers to travel freely through the new capital but also connect with other units to handle our requires. And the "tunnel" is a combination of highway and public transportation. With the help of the tunnel, people can reach their destination quickly without destroying huge amount of rainforest and also shorten the distance between us and the nature.

## Culture

The Indonesian cultures are also being used everywhere in our design. We combined the port market and the traditional long-house (rumah panjai) in Kalimantan to show the local features to new residents. Meanwhile, we also used rafflesia (the Indonesia National emblem) as the prototype of our train station, hoping that we can make the new rainforest city more colorful.

