

VDWC-Virtual Design World Cup The 5th Student BIM & VR Design Contest on Cloud Services
Theme 2015 "Redevelopment of Keelung Station Area in Taiwan"

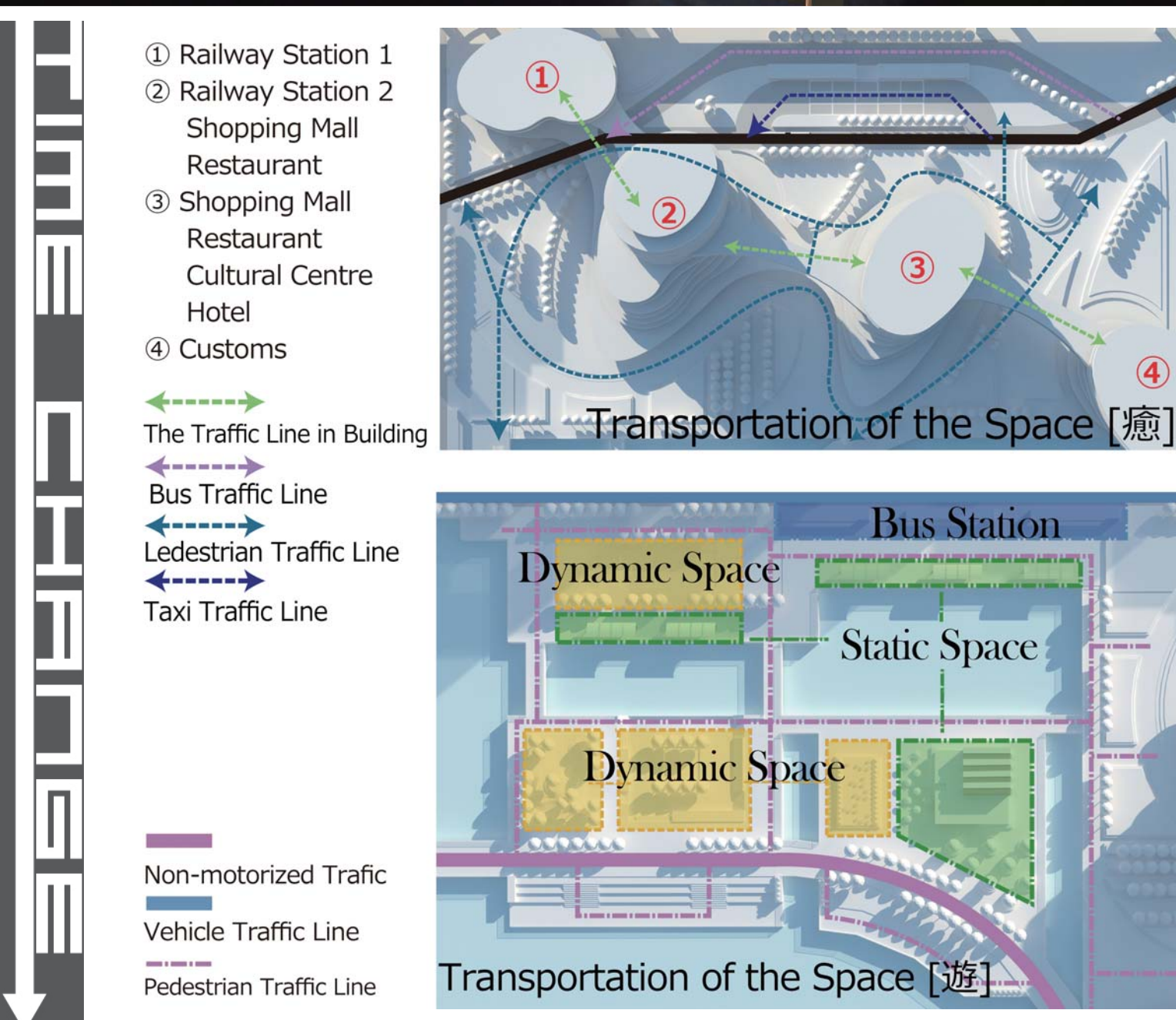

Background

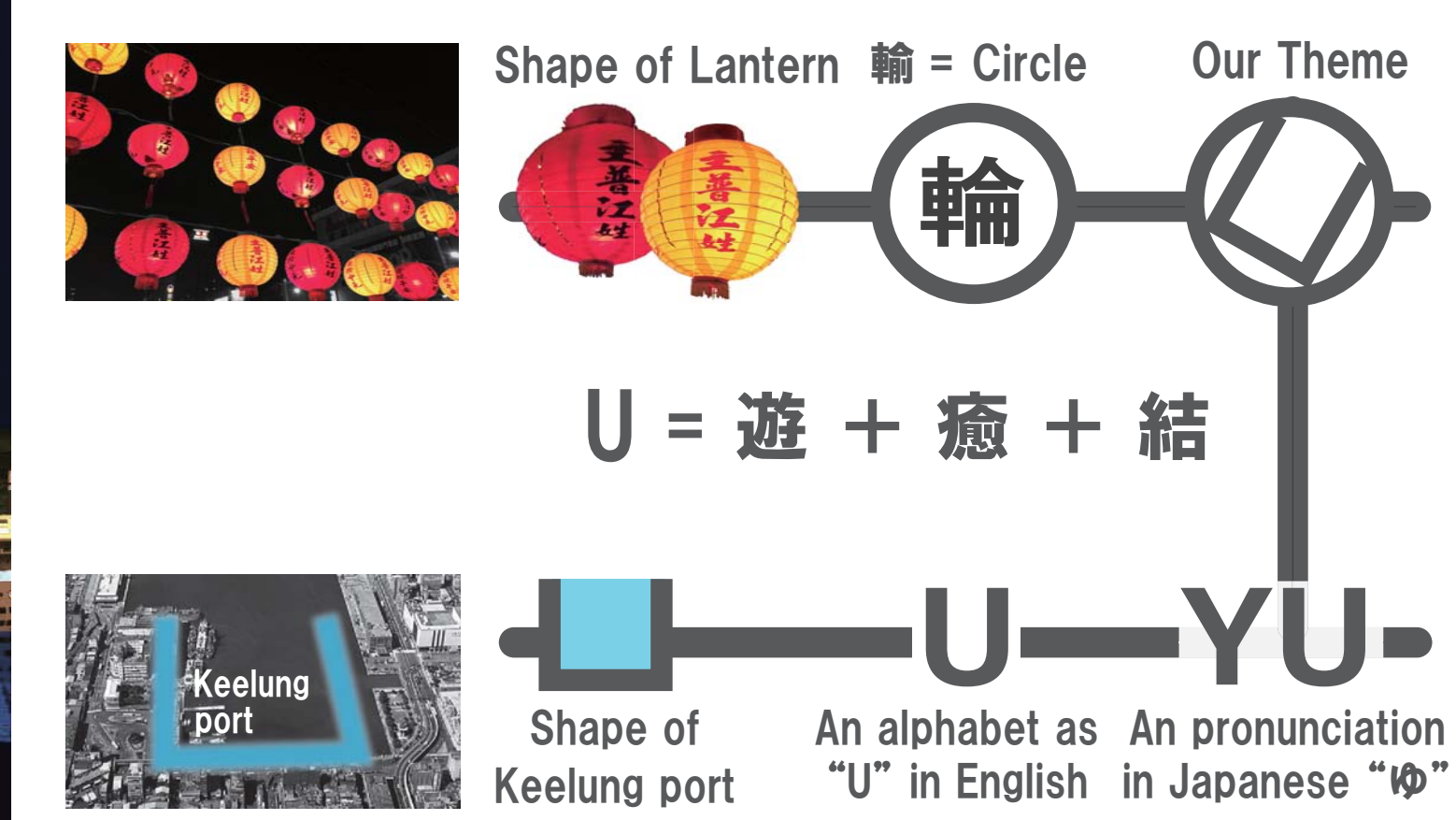

Concept

- We aims to the following three things in the competition.
- 「遊」 -YU : Amuse at the Keelung U port.
- 「癒」 -YU : Heal travelers and residents.
- 「結」 -YU : Unite Keelung and World.

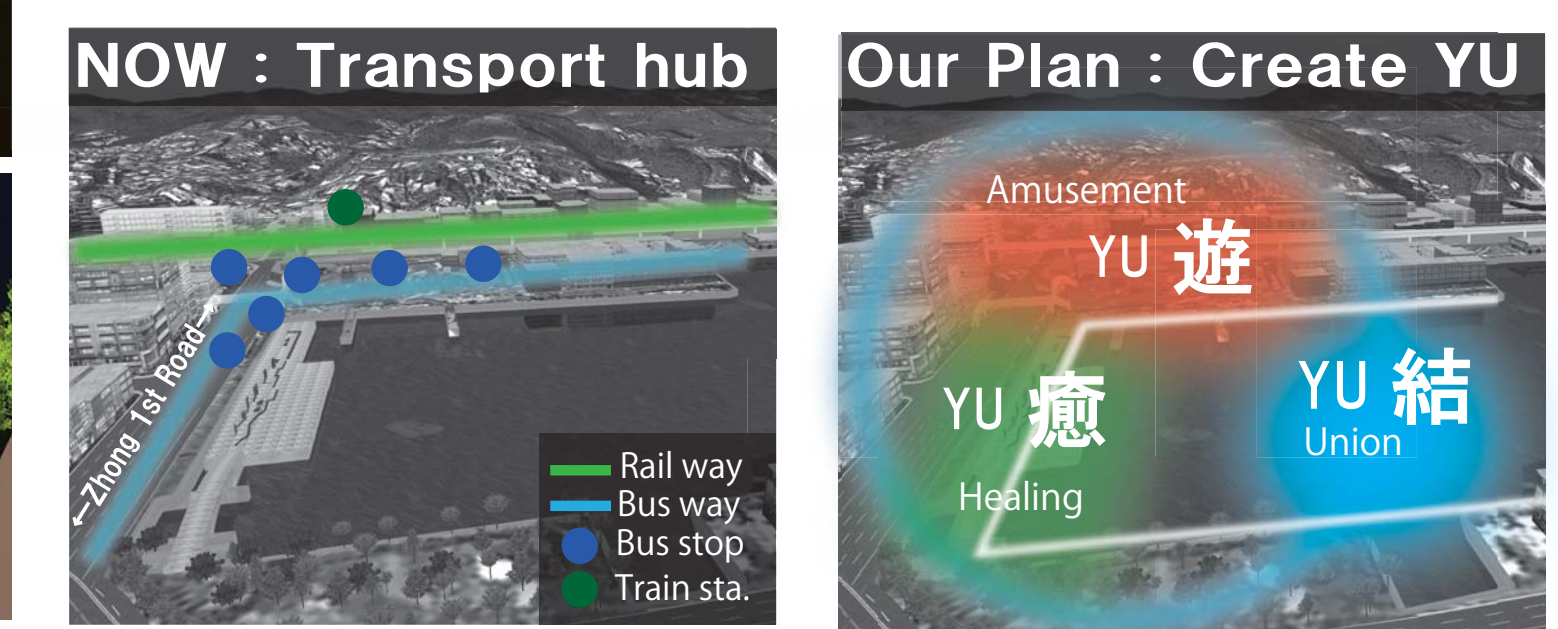

Design Model

- Motif of design models are Lantern . Lanterns in Keelung are very famous. Shape of them are circle and lines for engaging the circles. So we build 4 cooperative buildings for “遊” .
- Nowadays, Traffic systems in Keelung has difficulties due to many dispersed bus stops. We need to resolve a problem of Zhong 1st road with many traffic demand .
- 2 roads behind of 4 buildings are restricted any cars without Bus and Taxi. Bus stops are united one large space. It can realize a comfortable transportation.
- A roll of Parks is “癒” . There are lack of access to green and water in Keelung U port. We placed many greens and some facilities. It aims to heal traveler and residents.

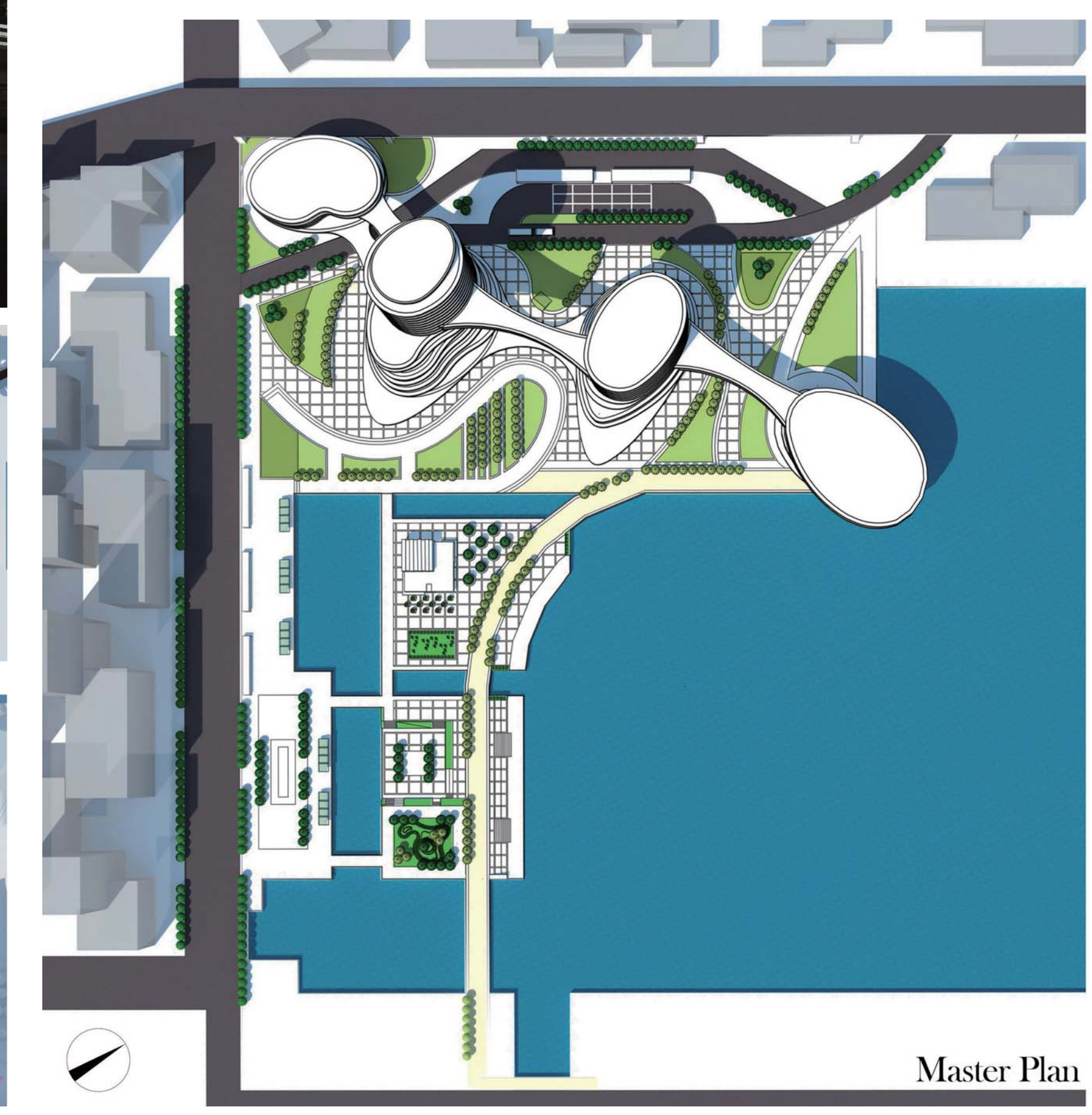

Night Design

- Our unique point of VR is to express many night landscapes .
- Keelung city have beautiful night scene.
- Uc-win/road” can design the detail of light design. We designed lightness by many parameters and graphics.

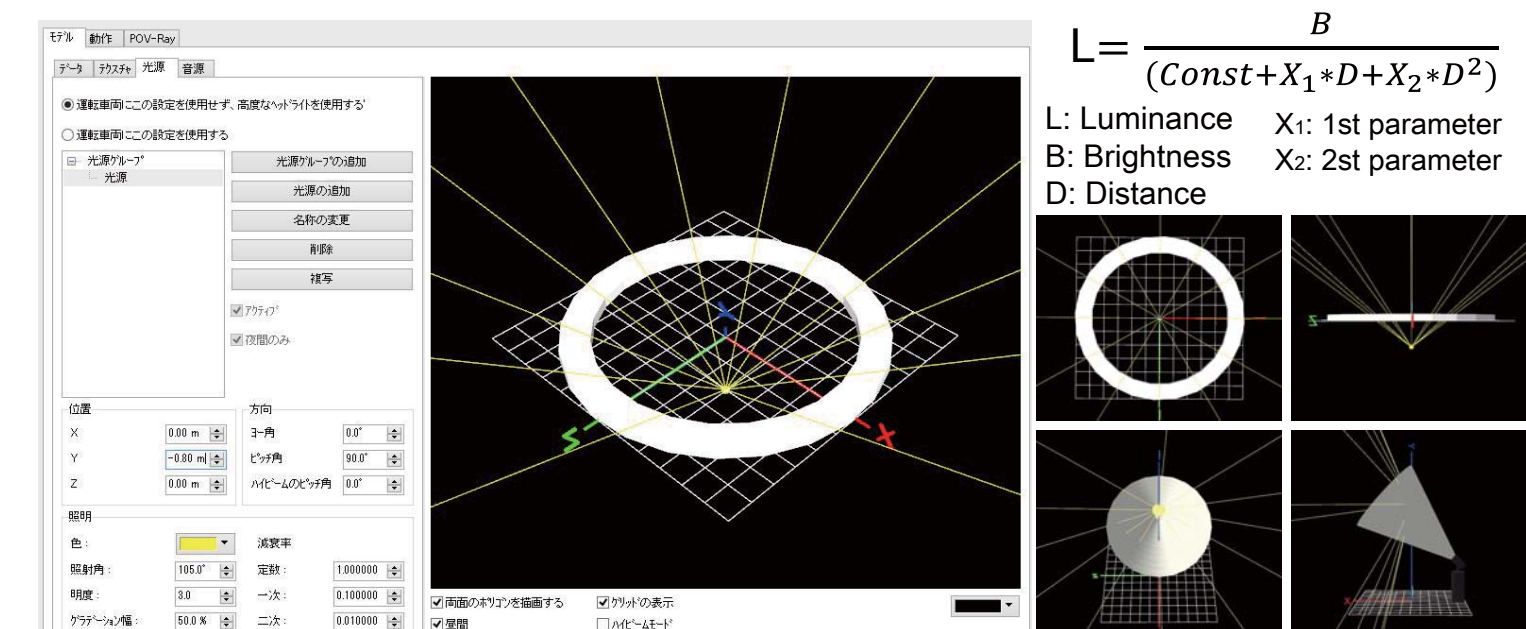

- We created many circles at the “U PORT” to express “輪” .
- Walls of each 4 buldings is like a circle. Each buildings are united by bridges. This means Lanterns of Keelung for uniting the World.

