

ORIGIN HILLS

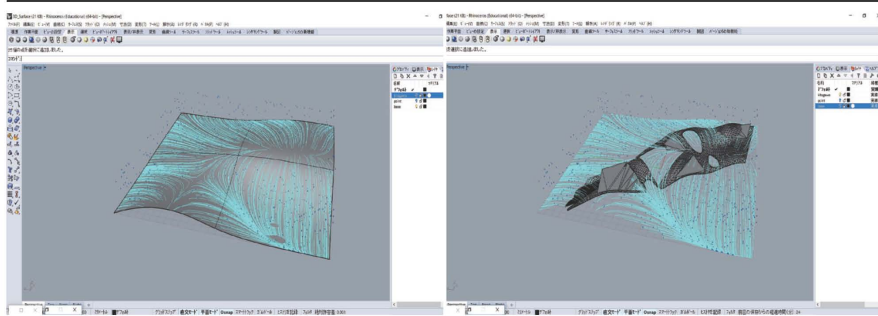

7.Rainwater analysis



Hill in the form of area there is a residence, inclination that can save the rain water efficiently has become a determining factor. Place a reservoir under the intersection, aimed such forms as to concentrate on the one point.

8.Sun light analysis

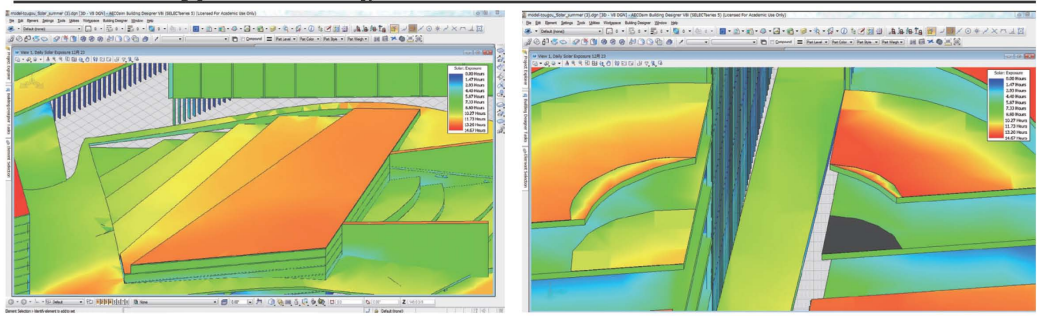

In the hills, and placed on stage on the ground, it made the amount of solar radiation of the gradient. In the strong place of the amount of solar radiation is carried out power generation becomes the space for human activities is a weak place. The plant was passed through the light to in.

1.PROPOSAL

Melbourne's people have intimate relations with trees. But nowadays, urban development scale is becoming bigger and bigger. Or Buildings constructed become higher and higher. Therefore people are losing interest in the city. So that we propose the city not only solve the traffic problem like the tram but also recreate the relationship between the human and the tree. The city we proposed will bring the people interest in the city and the people may contact the city like the trees.

2.DESIGN CONCEPT

2-1_Artificial ground

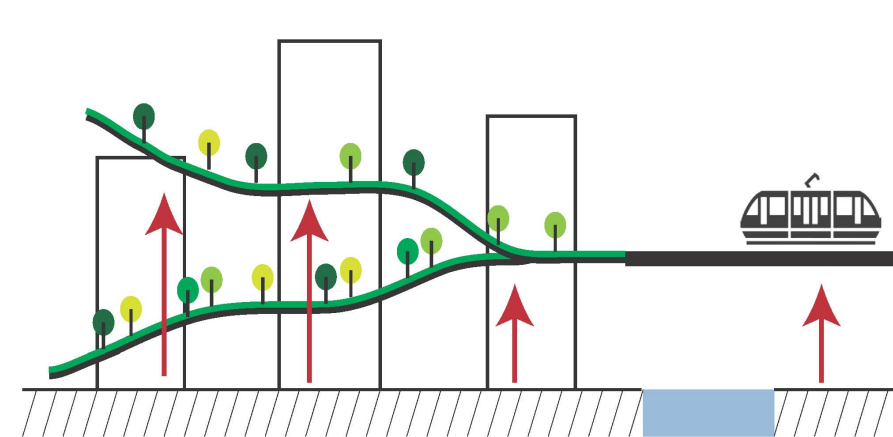

Elevated issues of LRT will be resolved by the artificial ground. Is lifted high trees from the ground is a symbol of this city, and caused a lot of people visit the rooftop garden.

2-2_Natural environment system

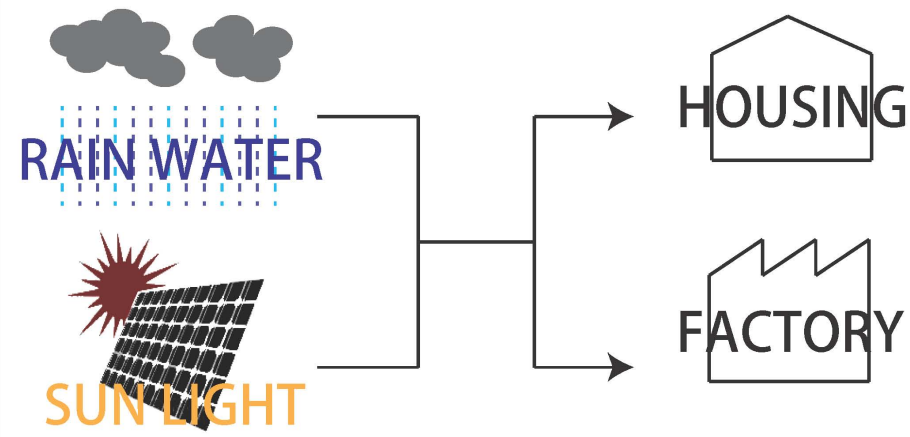

This proposal is to use rainwater and solar architecture (factories, housing, etc.). These systems achieve a sustainable city.

3.Tool cooperation

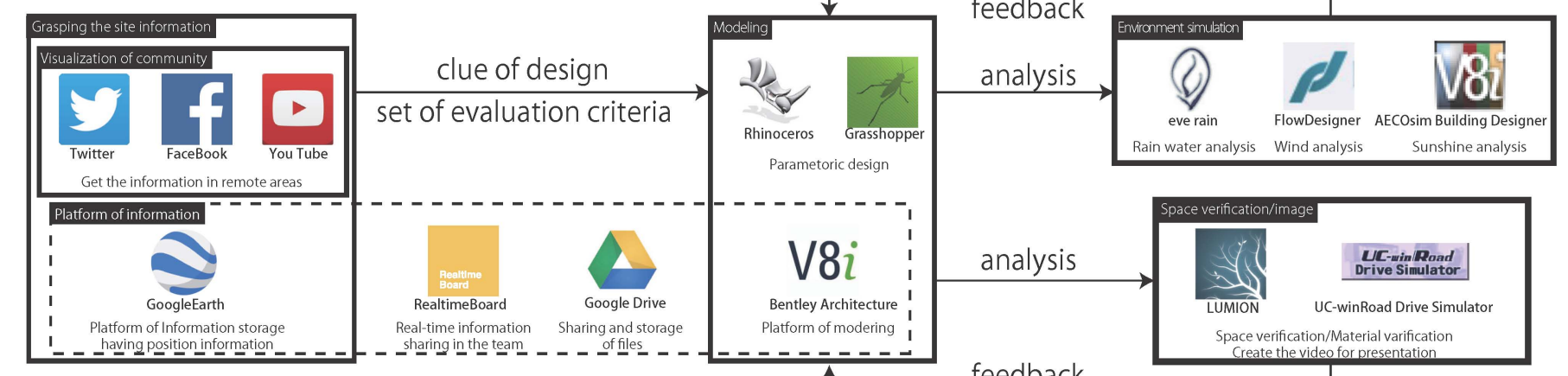

4.PROCESS CHART

Master plan Reading Site

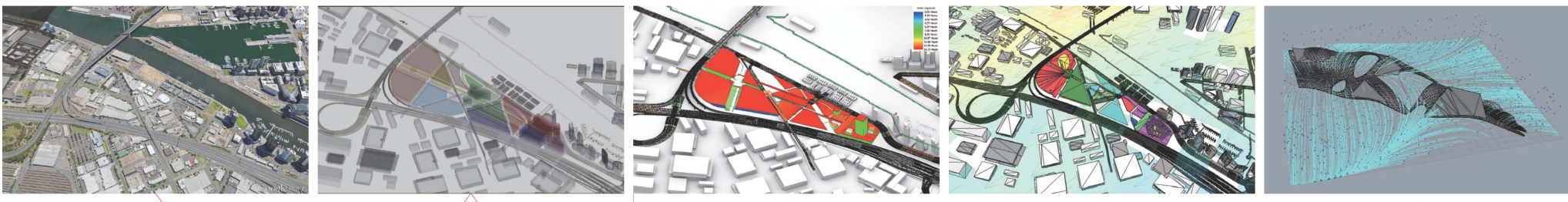

Tool Collaboration Diagram

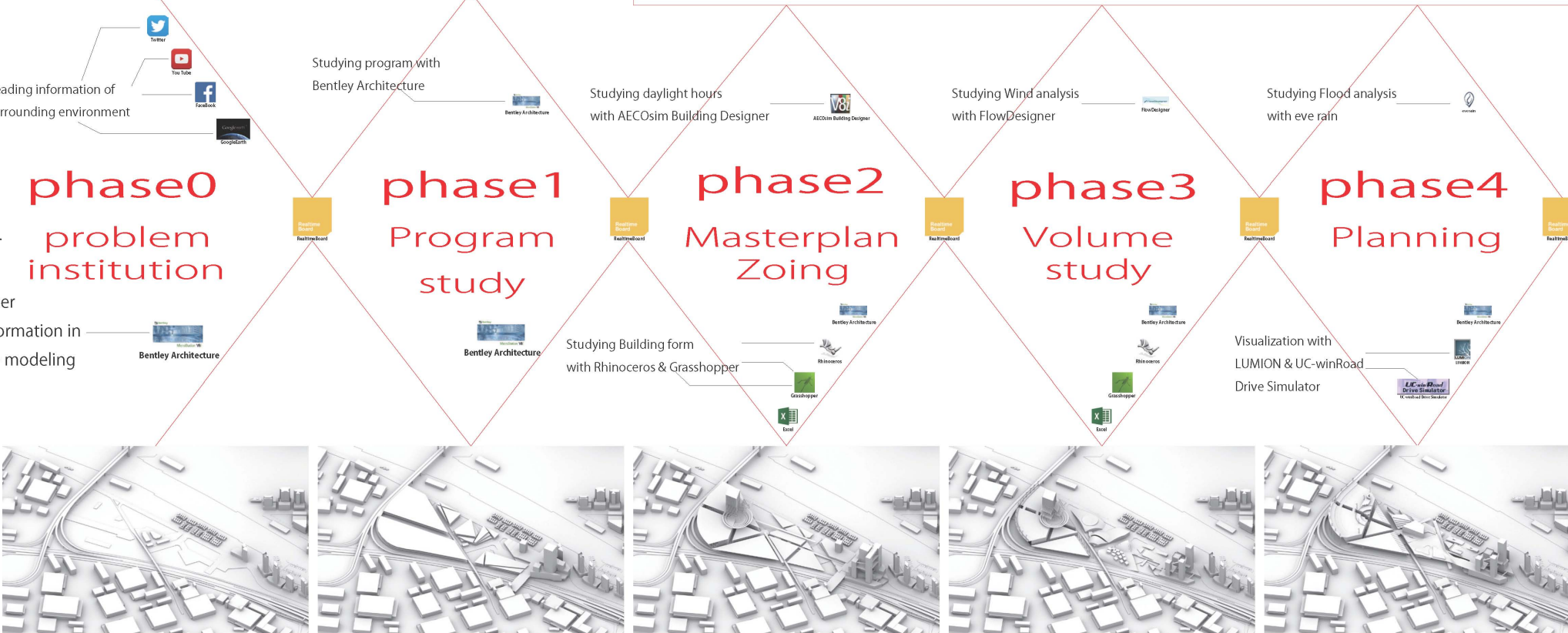

Building form Process

6.System diagram

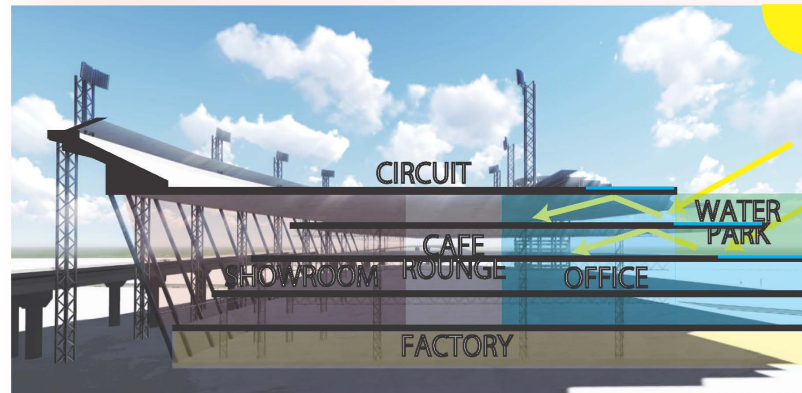

Office is illuminated by natural light that is reflected by the basin. Car through the highway can see the car that is on display in the showroom. Circuit, which is provided on the roof is able to test drive a car that has been developed in a car factory. In addition, from time to time in the circuit, Motor Show is opened. Office and showroom connect seamlessly by a cafe lounge.

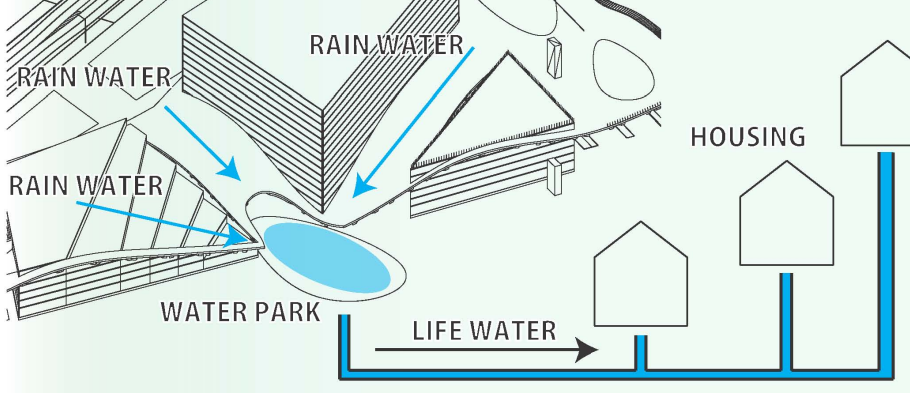

There is a gentle slope on the roof. Rain water flowing down from the roof will be the water park. Accumulated rain water is carried in a residential area. And, to use as domestic water.

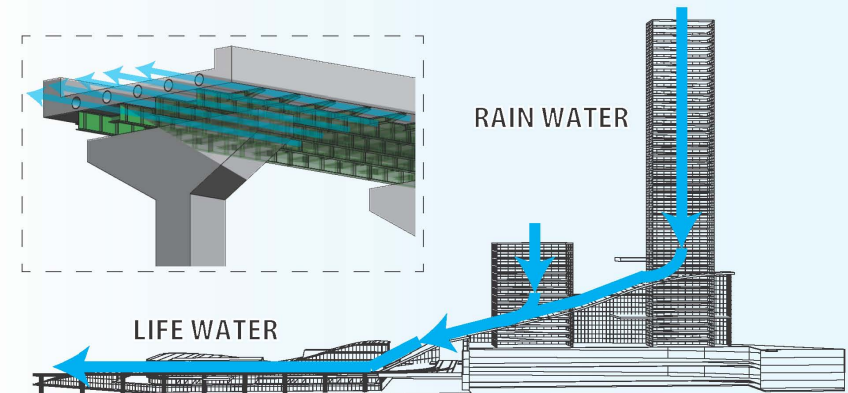

Four of the building is a huge filtration device. Leverage as living water of residential area by filtering the rainwater. Those of water is carried through in the flyover.

5.MASTER PLAN

