

THE CONNECTING CENTER

INTRODUCTION:

“**The Connecting Center**” is a redevelopment plan for Yangon. Our goal is turning Yangon into a sustainable model city with high quality environment and connection rate, to be Asia's Most Liveable City. To make that dream come true, **MPT** team has an idea of designing and planning Yangon city focusing on solving 3 main issues of Yangon: **Traffic Connection Problem**, **Disaster Prevention Problem** and **Living Problem**. The functions of BIM/CIM and VR will be applied in the design processes to simulate the transportation, disaster management and social infrastructure in this plan.

PLANNING MAP:

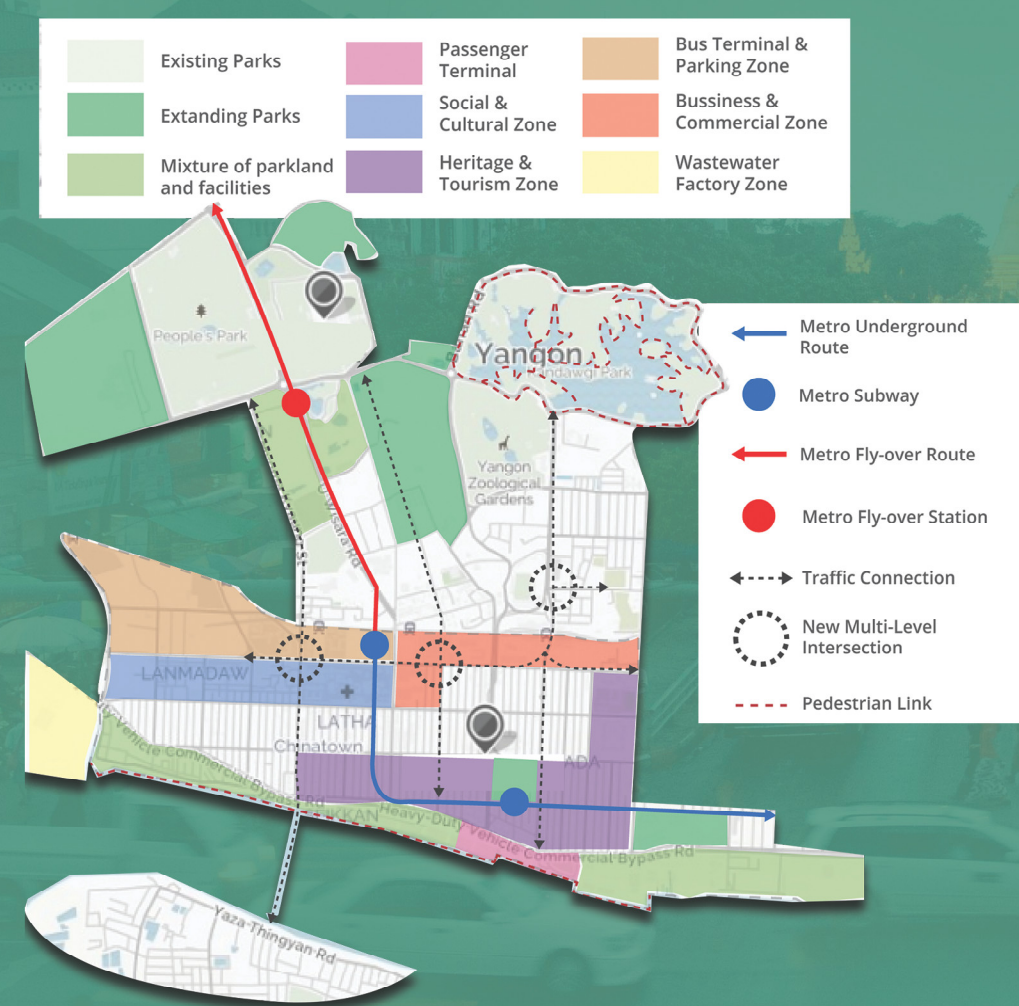

Firstly, Yangon must have a strong public transport system in place if it is to reach its full safety and liveability potential. This involves upgrading the existing circle line, diversifying and improving public transportation system; using the park land, lakes and rivers to establish new ferry links and providing walkable streets and bicycle lanes.

Secondly, Yangon must be able to weather future challenges, particularly major natural disasters. In this plan, sewage factory and green space system are built will help prevent disasters, include floods and smog.

Finally, Yangon is now lack of electricity and public assets; such as facilities for recreation, sports, entertainment, education and cultural activities can be accessible and available for all. More public facilities which provide spaces for exercise and recreation, cultural performances, and festivals are created. It will also boost Yangon's tourism and arts economy at a time when contemporary Asian art is growing in global popularity.



2017

ICE-TECH: MPT



UC-winRoad

PARKING LOTS DRAW

SKETCHUP

1

TRAFFIC CONNECTION



Loops were linked to each other with a system of overpasses and underpasses across public streets, creating a grand loop around. New three intersections will allow for better flow of traffic, both vehicular and pedestrian



Compact cities rely on good public transport rather than cars and are designed to provide maximum access for pedestrians and cyclists. **Pedestrian way** beside lake which is a long loop, is also allow cyclists take part in. Access from the road to the footpath can be provided beneath trees by ensuring vendors do not block these spaces. **Bike Stops** provided as a mixed with **Bus Stops**. It will help people switch transportation types in the short time.



For aiming to make the city's street safer and more clearly, we have installed **traffic lights** with accompanying pedestrian cycles and painted **pedestrian crossings** at all major road crossing. More large **parking lots** are created by using available free space. Providing multi-level parking such as **underground car garage** to relieve pressure on nearly neighborhood streets. It's also avoid limited on-street parking situation and provides more space for setting up pedestrian network.

Multi-levels Metro System

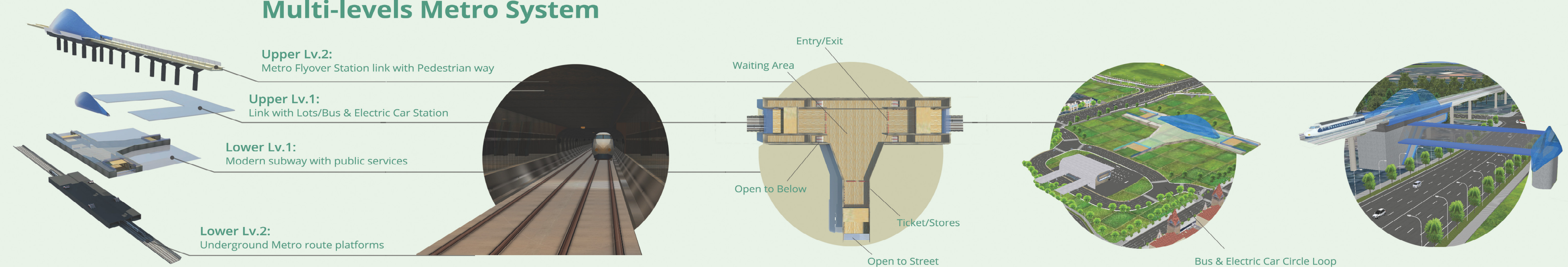

2

DISASTER PREVENTION



3

LIVING



Kandawgi Park is largest park with pedestrian belt in this plan. The lake inside is beautiful sightseeing, also is **flood prevention basin**. Parks can have a dedicated and self-contained walking and biking path.



Sewage Factory is waste water treatment factory, has been designed for water recovery and meeting environmental regulations.

Car Recycling Factory is a solution we have choose to handle car designing problem. New car design will adapted to right hand traffic rule in Yangon. Then, accident fatalities will be decreased

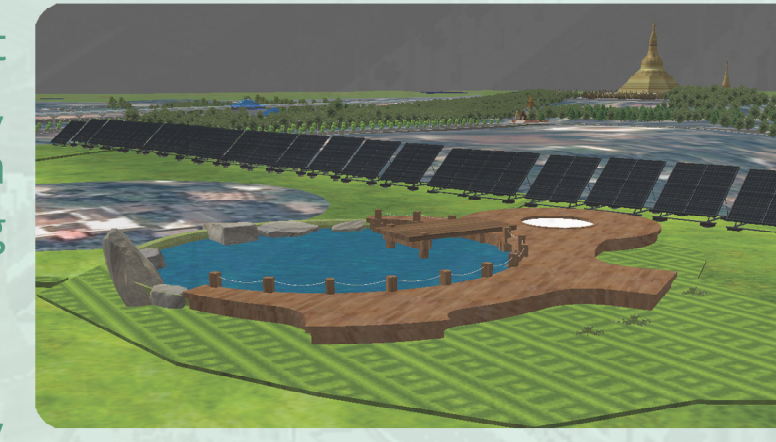

Aung San Stadium is now more attractive with parking lots were upgraded. Pedestrian even can access stadium through two green ramps from both sides of parking lots.



The waterfront has been redeveloped for public use with a mix of new public parks, connect concert and hotels. **Green Harbor** is mixture park land facility, where people can connect together on fesivals, entertainment activities, ...

With **Solar Panel System**, Yangon will has more energy to serves citizens life and lights up important facilities at night.