

# Infrastructure Connect System

The space use is optimized by leveraging its vertical space with our "Entrance-connect" and the building used by this vehicle.

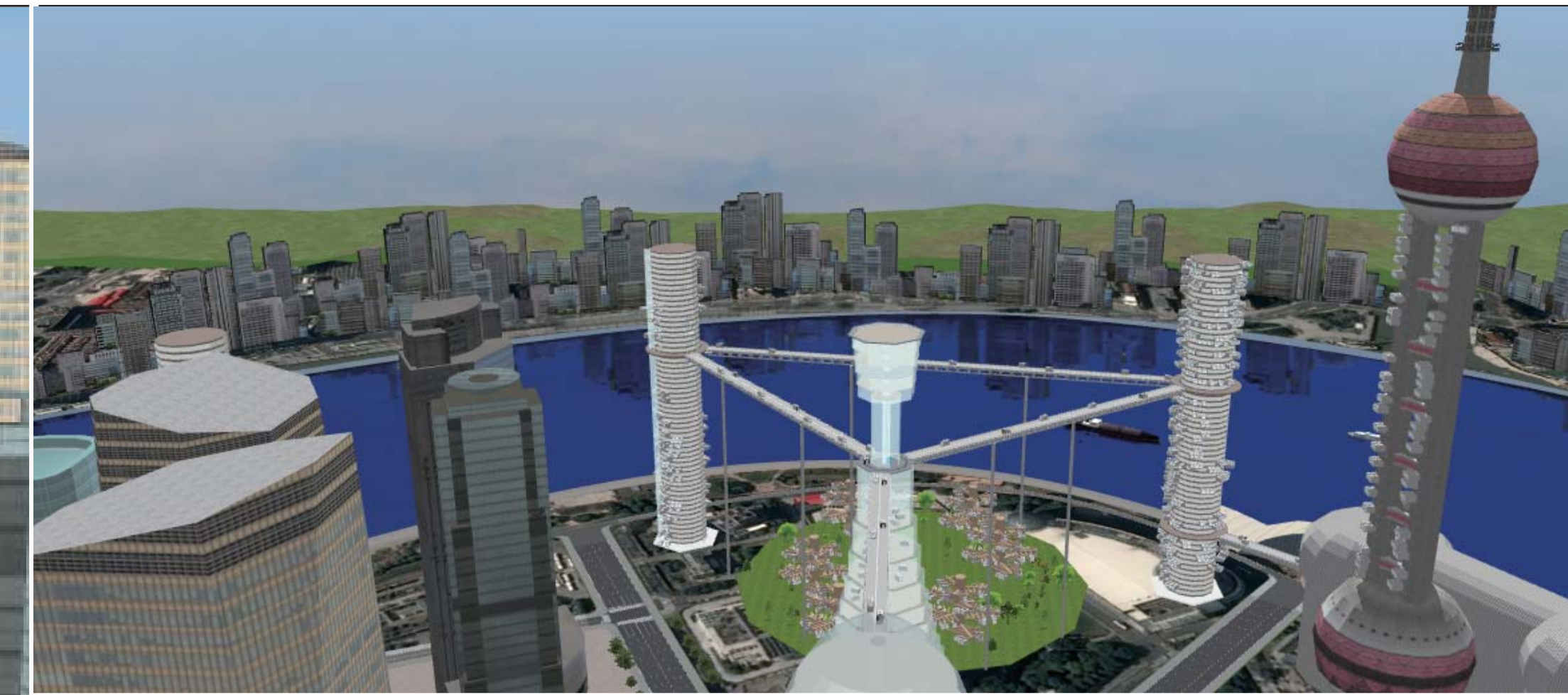

## 1. abstract

### The Connect System

● infrastructure ● architecture

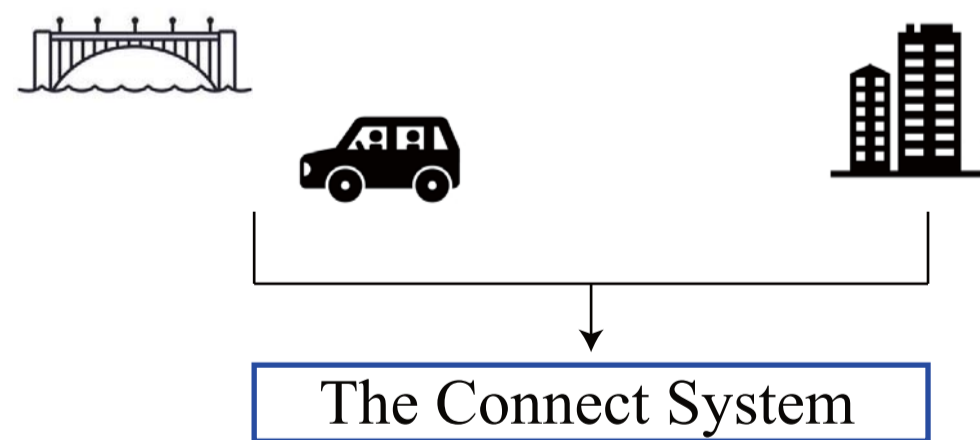

While a conventional lifestyle requires people to walk from a train station to an office or a school, our "merging infrastructure and architecture" proposal reduces transportation transfers and ultimately creates more free time to users.

### The Connect System

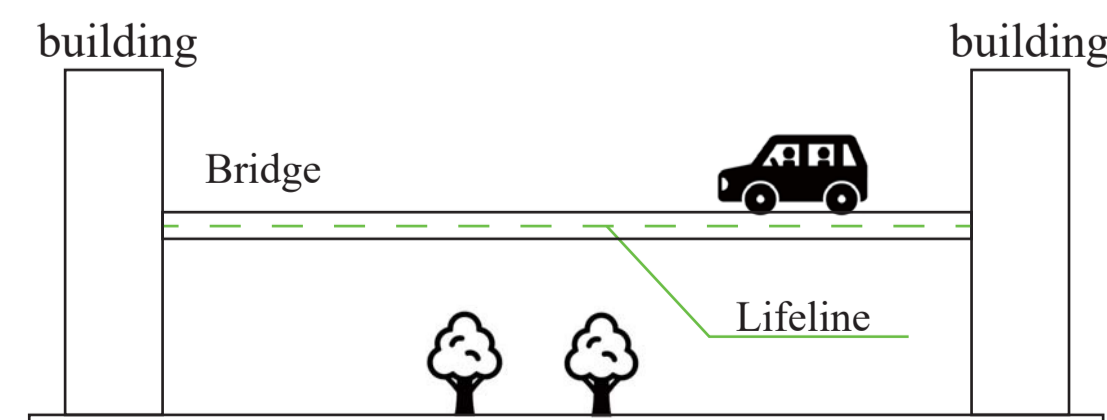

Bridge is not only used for transportation, It connects lifeline also.

## 2.our ideas

### Entrance-Connect

#### Interior

Collapsible bench and bed make space when don't use them. This room has storage.

#### Automatic driving

This vehicle is installed automatic driving. It makes passenger relax more and focus on what they do.

#### Window

Small windows in this room allow more sunlight to be brought into this room.

#### Blocks

Connect or climb building by 4 cubes which are back of this vehicle.

#### linear motor

This vehicle doesn't have wheels. It is installed linear motor. So it is moved by magnetic force.

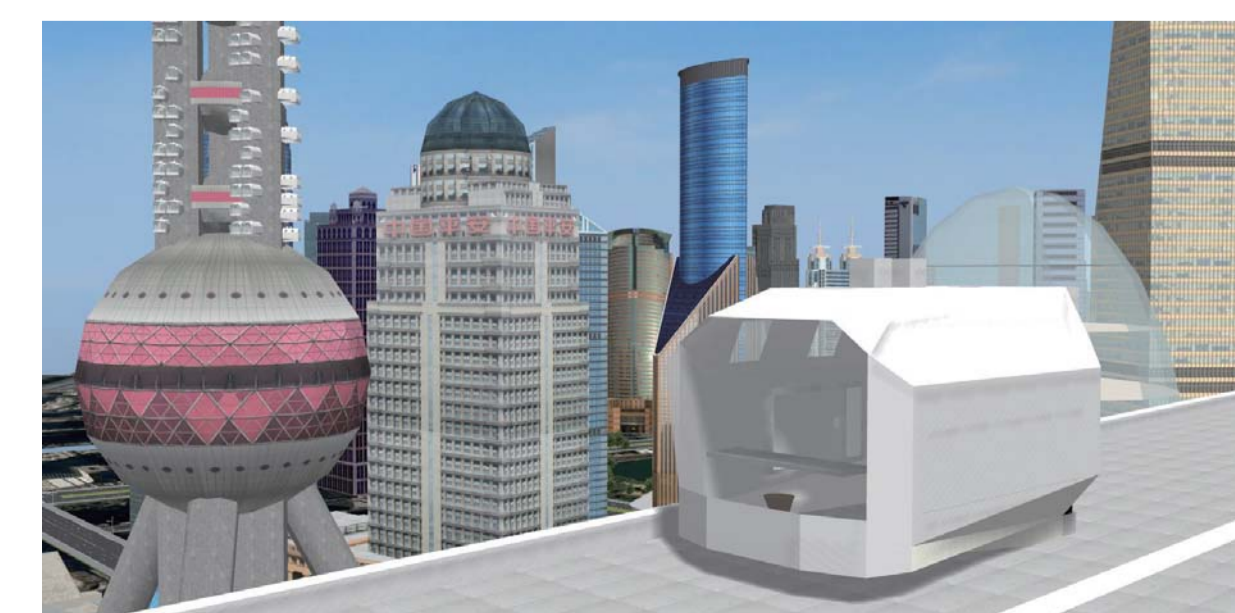
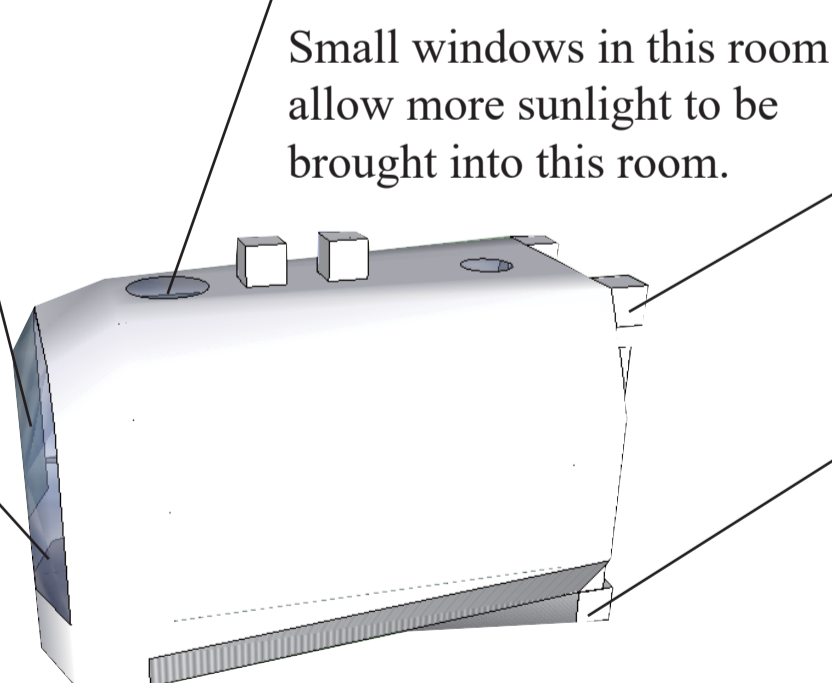

### Connect with building



This building can be shared by everyone. Vehicle can connect with this building. Therefore, it can be used as a meeting room on weekdays and can be used for party and event on holidays. In addition to this, vehicle can be personal office. People don't need to find parking lot.